

# FOLDING POCKET DOOR SYSTEM (INSET)

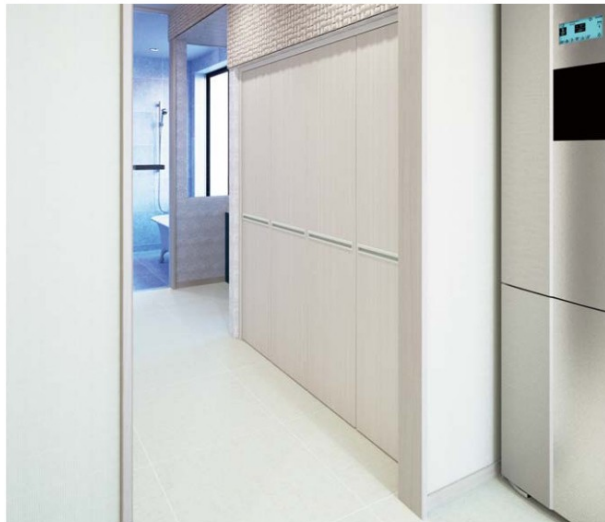

**ALT-F**



Door Width	Max. 450 mm
Door Height	Max. 1830 mm
Door Thickness	23 ~ 30 mm
Door Weight	Max. 10 kg/Door

By using additional parts, Door Height Max 2400mm(Max 10kg/Door) possible. Please contact us for the details.

## ■ Features

Folding door is stored inside the cabinet.

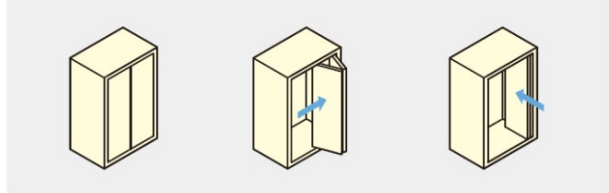

## ■ Top View

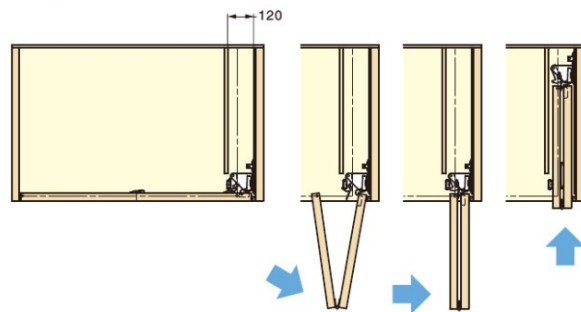

## ■ Installation

Door storing  
355.6 (ALT-F18)  
406.4 (ALT-F20)

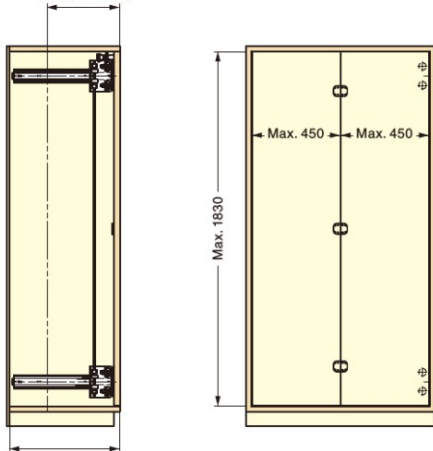

Min. cabinet depth  
Min. 466.7 + Door thickness (ALT-F18)  
Min. 517.5 + Door thickness (ALT-F20)

## ■ Rail Dimensions

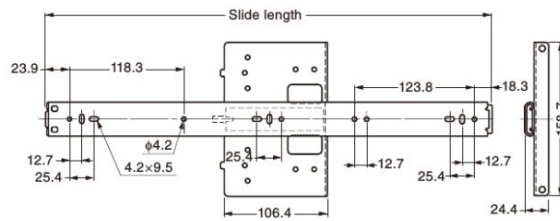

Item Name	Opening	Rail Length	Door Storing	Cabinet Depth
ALT-F18L	Left Opening	460.4	355.6	Min. 466.7 + Door Thickness
ALT-F18R	Right Opening	460.4	355.6	Min. 466.7 + Door Thickness
ALT-F20L	Left Opening	511.2	406.4	Min. 517.5 + Door Thickness
ALT-F20R	Right Opening	511.2	406.4	Min. 517.5 + Door Thickness

Parts Set		
Necessary Parts		
Please refer to "Qty [a]~[d]" for parts included in each set.		
Set Name	Item Code	Item Name
a Left Opening (Door Storing 355.6)	180-034-183	ALT-F18L
b Right Opening (Door Storing 355.6)	180-034-184	ALT-F18R
c Left Opening (Door Storing 406.4)	180-034-185	ALT-F20L
d Right Opening (Door Storing 406.4)	180-034-186	ALT-F20R

Parts Included

No.	Qty	Part Name	Dimensions	Description
1	2 pcs	Rail	See P.614	● Material Steel ● Finish Black Chromate
2	2 pcs	Rack	-	● Material ABS ● Finish Black
3	1 pc	Cap		● Material Steel ● Finish Black Chromate
4	4 pcs	Gear		● Material POM ● Finish Black
5	4 pcs	Bush		● Material POM ● Finish Black
6	4 pcs	Stationary Block		● Material POM ● Finish Black Screw : Binding Head Self Tapping Screw UNC8-32
7	2 pcs	Upper Rail Joint		● Material PA ● Finish Black Screw : Countersunk Head Tapping Screw 4.2 X 32
8	1 pc	Upper Rail Joint		● Material POM ● Finish White
9	1 pc	End Guide		● Material Steel (SPCC) / POM ● Finish Yellow Zinc Chromate / Natural
10	1 pc	Angle Stopper		● Material Steel (SPCC) ● Finish Nickel

Not for ALT-F.  
This part is not used.

No.	Qty	Part Name	Dimensions	Description
11	1 pc	Inner Guide		● Material POM ● Finish White
12	1 pc	Interlock		● Material Steel / POM ● Finish Black / White
13	3 pcs	Centre Hinge		● Material Steel ● Finish Black Screw : Countersunk Head Tapping Screw 3.5 X 16
14	1 pc	Hinge Cover Bracket		● Material Steel (SPCC) ● Finish Black Paint
15	2 set (4 pcs)	Hinge Set		Item Code : 180-026-432 Item Name : ALT-F-8086HKEZX ● Material Steel / Zinc Alloy ● Finish Yellow Zinc Chromate / Black

Rail		Necessary Parts			
1 pc is necessary for a pair of doors.					
No.	Qty	Item Code	Part Name	Dimensions	Description
16	1 pc	250-017-148	Upper Rail (1820 mm)		● Material Aluminium ● Finish Anodized Silver
		Item Name FD30-HBR 1820SIL	Bore Pitch : Approx. 300 mm Pitch End : Approx. 30 mm		
17	1 pc	250-019-971	Bottom Guide Rail (1500 mm)		● Material Aluminium ● Finish Anodized Silver
		Item Name FD30-HBRT 1500SIL			

Shaft		Necessary Parts				
1 pc is necessary for a pair of doors.						
No.	Length	Qty	Item Code	Part Name	Dimensions	Description
18	902±13 mm	1 pc	180-121-047	Shaft		● Material Steel ● Finish Black Chromate
		Item Name 29475-36				
		1207±13 mm	180-121-048			
		Item Name 29475-48				
20	1816±13 mm	1 pc	180-121-049			
		Item Name 29475-72				